

**SEPTIC SYSTEM SETBACK REQUIREMENTS**  
ONTARIO BUILDING CODE, ARTICLE 8.2.1.6:

**8.2.1.6. Clearances for a Class 4 or 5 Sewage System**

(1) Except as provided in Sentences 8.2.1.4.(1) and (2), a treatment unit shall not be located closer than the minimum horizontal distances as set out in Table 8.2.1.6.A.

**Table 8.2.1.6.A. Minimum Clearances for Treatment Units**  
Forming Part of Sentence 8.2.1.6.(1)

Column 1	Column 2
Object	Minimum Clearance, m
Structure	1.5
Well	15
Lake	15
Pond	15
Reservoir	15
River	15
Spring	15
Stream	15
Property Line	3

(2) Except as provided in Sentences 8.2.1.4.(1) and (2), a distribution pipe shall not be located closer than the minimum horizontal distances set out in Table 8.2.1.6.B, and these distances shall be increased when required by Sentence 8.7.4.2.(11).

**Table 8.2.1.6.B. Minimum Clearances for Distribution Piping**  
Forming Part of Sentence 8.2.1.6.(2)

Column 1	Column 2
Object	Minimum Clearance, m
Structure	5
Well with a watertight casing to a depth of 6 m	15
Any other well	30
Lake	15
Pond	15
Reservoir	15
River	15
Spring not used as a source of potable water	15
Stream	15
Property Line	3

LANDS TO BE SEVERED  
(10.93ha)

LANDS TO BE RETAINED  
(2.91ha)

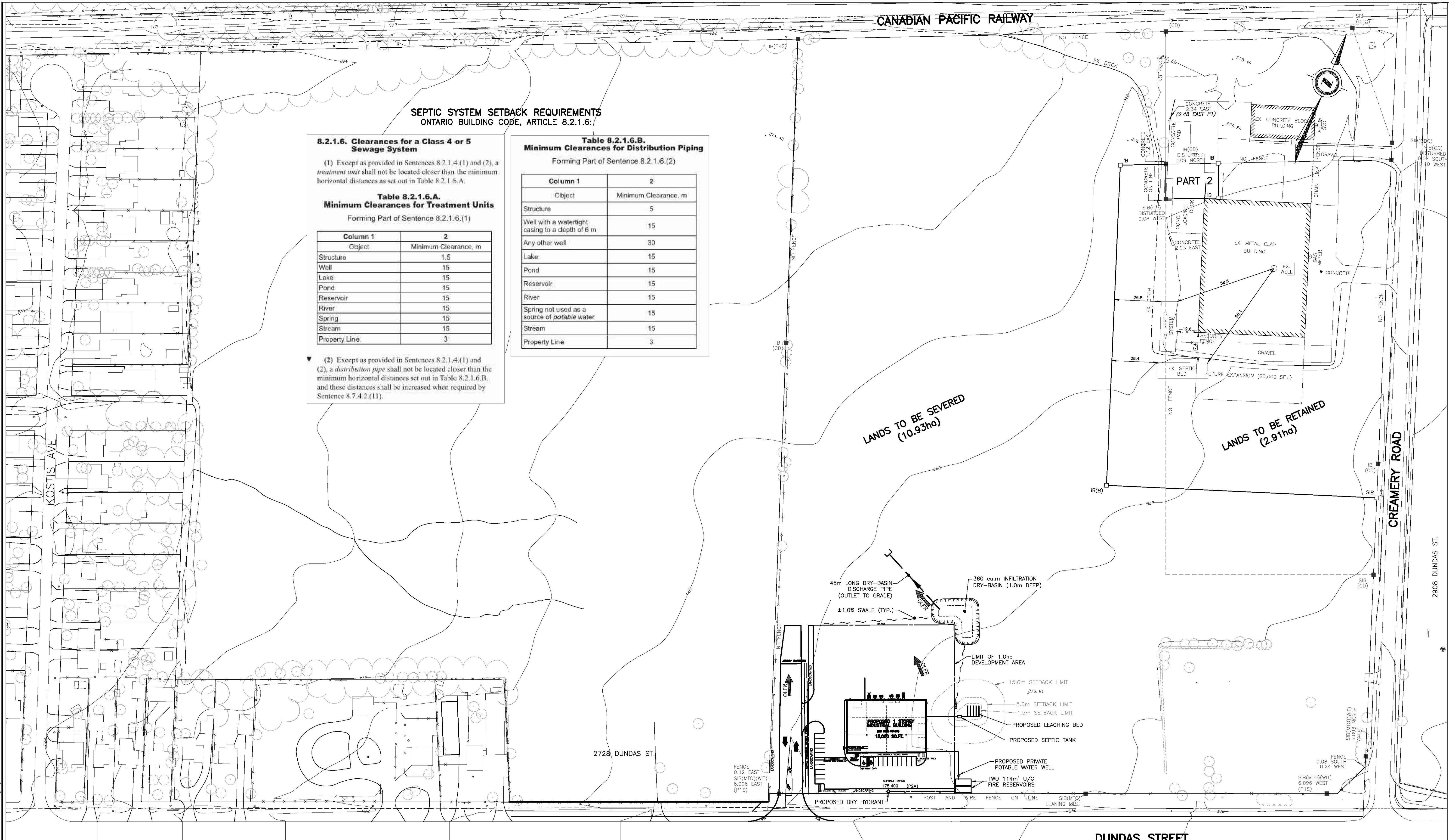

EXISTING SERVICES	DRAWING #, SOURCE	DATE	AS CONSTRUCTED SERVICES	COMPLETION	DETAILS	No.	REVISIONS	DATE	CONSULTANT
					DESIGN BY PJB	1	ISSUED FOR CONSENT APPLICATION	APR. 17/20	DEVENG
					DRAWN BY JC/RJB	2	REVISED SITE PLAN	FEB 21/24	DEVENG
					CHECKED BY JS				
					F.B.K. ***				

CONSULTANT OR DIVISION	ENGINEER'S STAMP
London Office 41 Adelaide St. N., Unit 71 (519) 672-8310  Paris Office 31 Mechanic St., Unit 301 (519) 442-1441	<p>development engineering CONSULTING CIVIL ENGINEERS</p>

**APPROVALS DRAWING ONLY**  
DO NOT USE FOR CONSTRUCTION

SCALE: 1:1000

SCALE - 1:1000  
0 10 20m

**DANCOR CREAMERY INC.**  
1425 CREAMERY ROAD

**PRIVATE SERVICING LAYOUT PLAN**

PROJECT No. **DEL19-072**  
SHEET No. **1**  
PLAN FILE No.