

WEBSTER STREET

CROATIA ROAD

SANDRA ROAD

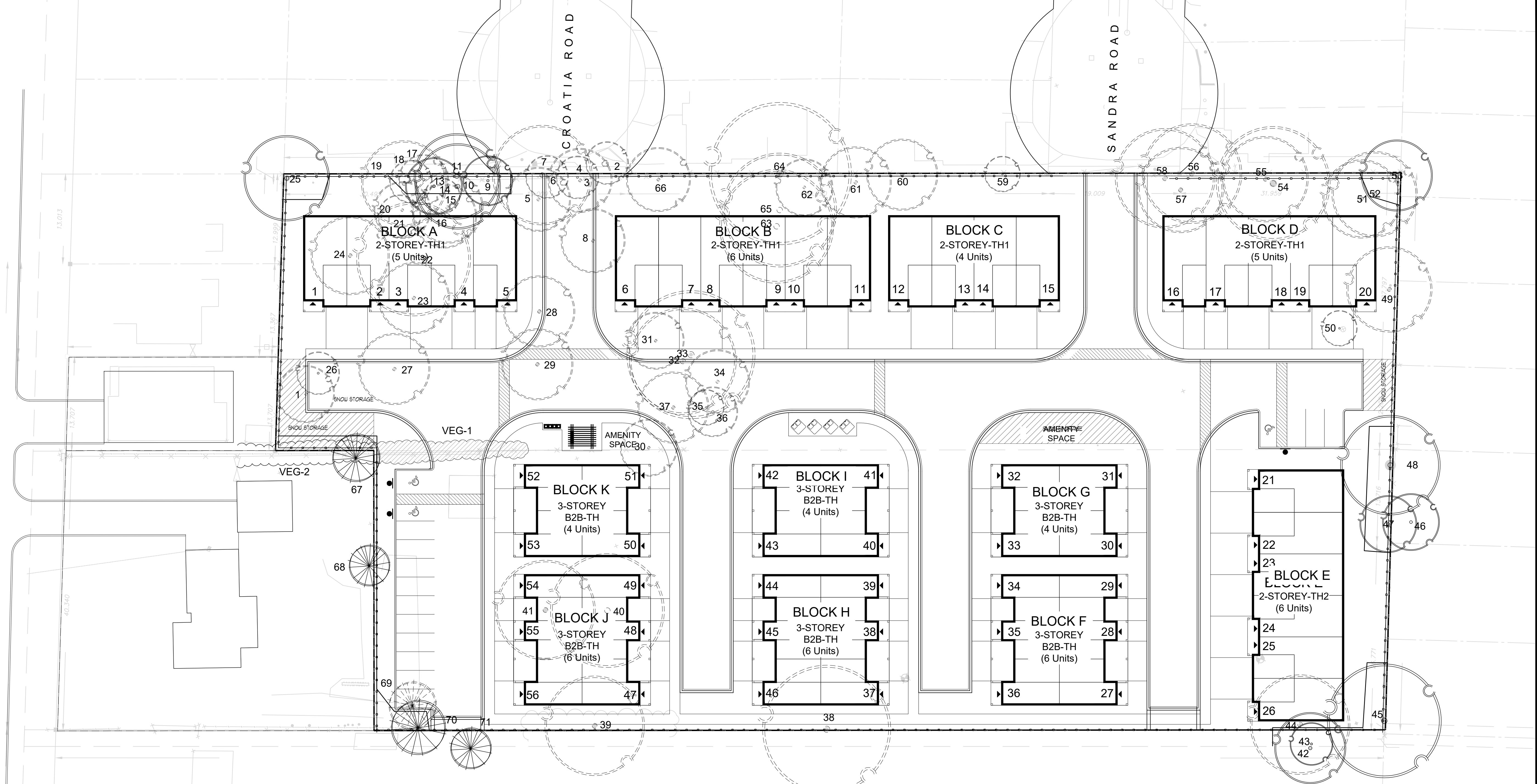

**TREE PRESERVATION PLAN**  
SCALE = 1:300

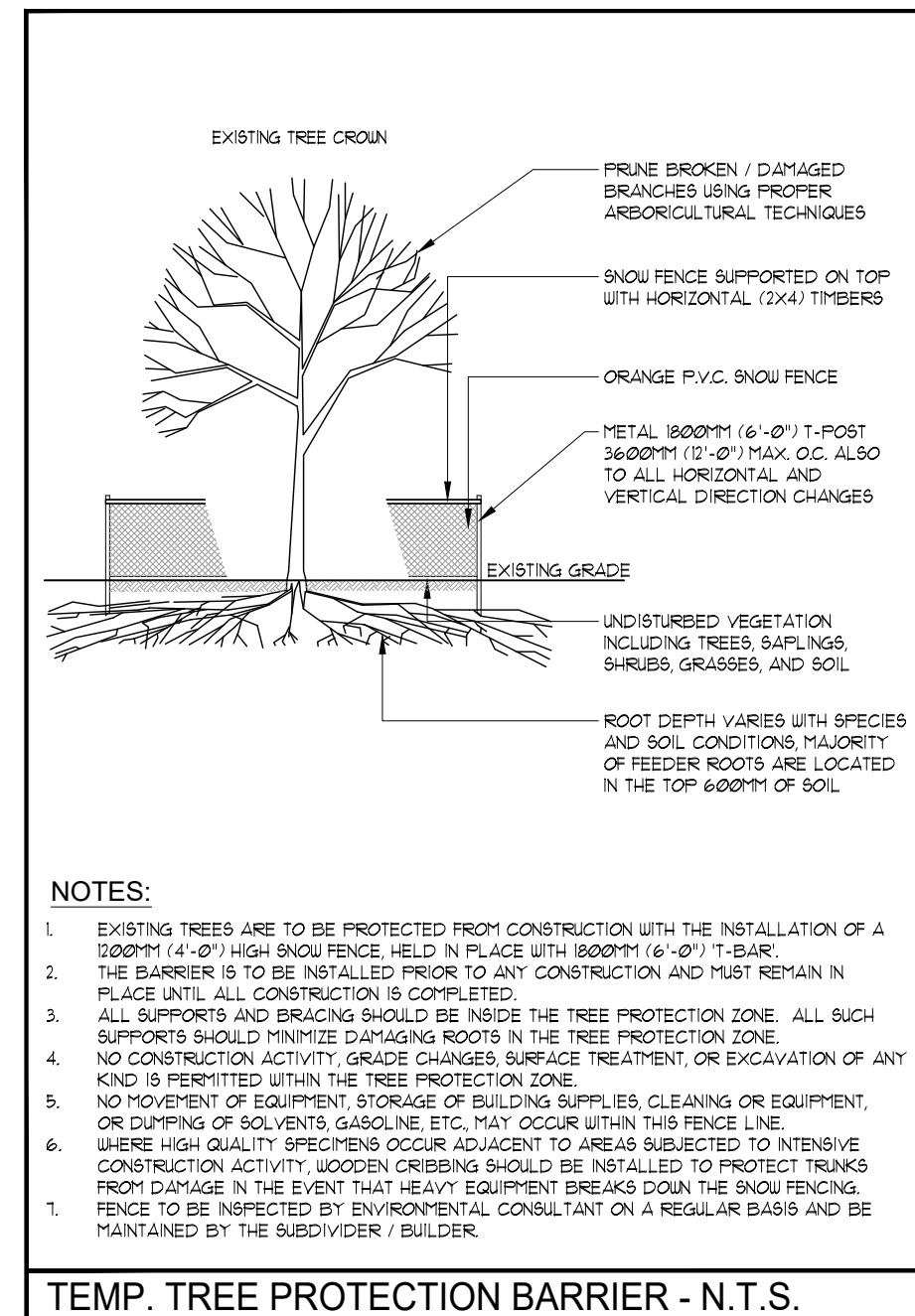

**LEGEND**

	EXISTING DECIDUOUS TREES TO REMAIN
	EXISTING DECIDUOUS TREES TO BE REMOVED
	EXISTING CONIFEROUS TREES TO REMAIN
	EXISTING CONIFEROUS TREES TO BE REMOVED
	EXISTING PLANTINGS TO REMAIN
	EXISTING PLANTINGS TO BE REMOVED
	TREE PROTECTION BARRIER

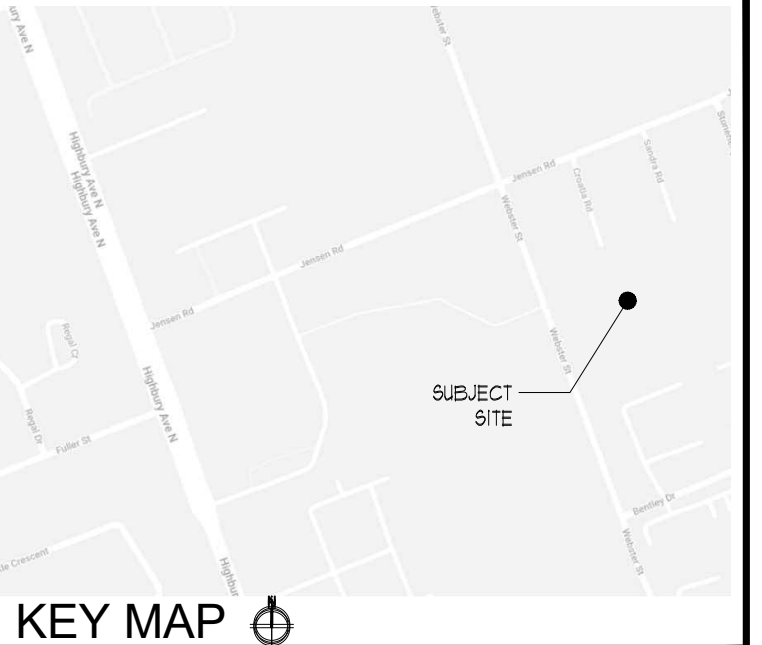

ALL DRAWINGS REMAIN THE PROPERTY OF THE LANDSCAPE ARCHITECT AND SHALL NOT BE REPRODUCED OR REUSED WITHOUT THE LANDSCAPE ARCHITECTS WRITTEN PERMISSION.  
THIS DRAWING SHALL NOT BE USED FOR CONSTRUCTION OR TENDER PURPOSES UNLESS SIGNED AND DATED BY RONALD H. KOUDYS, O.A.L.A. C.S.L.A. LANDSCAPE ARCHITECT, LONDON, ONTARIO (519) 667-3322.

Ronald H. Koudys, O.A.L.A. C.S.L.A. DATE

DATE	DESCRIPTION	No.
2024-05-08	ISSUED FOR ZBA	2.
2024-03-14	ISSUED FOR REVIEW	1.

PLOTTING INFORMATION:  
PLOTTED DATE = 2024-05-08  
PLOTTED SCALE = 1:1

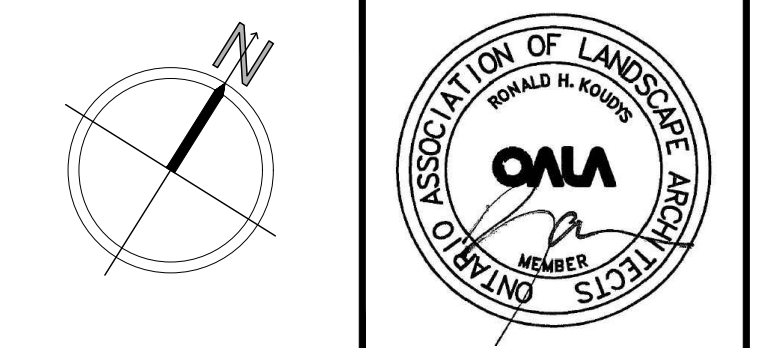

PROJECT TITLE:  
**2 STOREY TOWNHOMES**  
1356 WEBSTER STREET  
LONDON, ON

**TREE PRESERVATION PLAN**

DATE: MARCH, 2024	SCALE: AS NOTED	DRAWING No.:
DRAWN: RKL/A Inc.	CHECKED BY: RHK	T-1
PROJECT No.:		

WEBSTER STREET

CROATIA ROAD

SANDRA ROAD

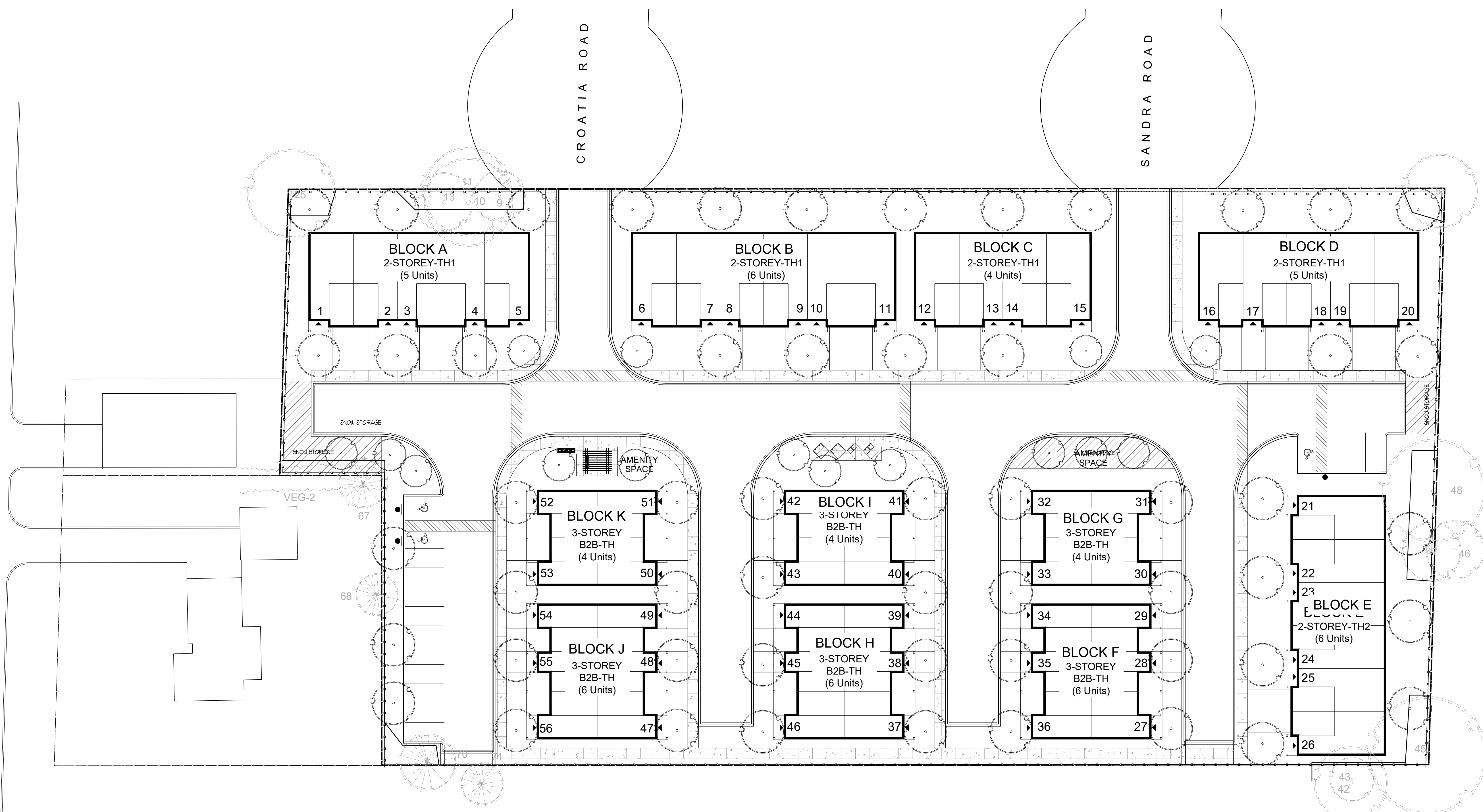

**LANDSCAPE PLAN**  
SCALE = 1:300

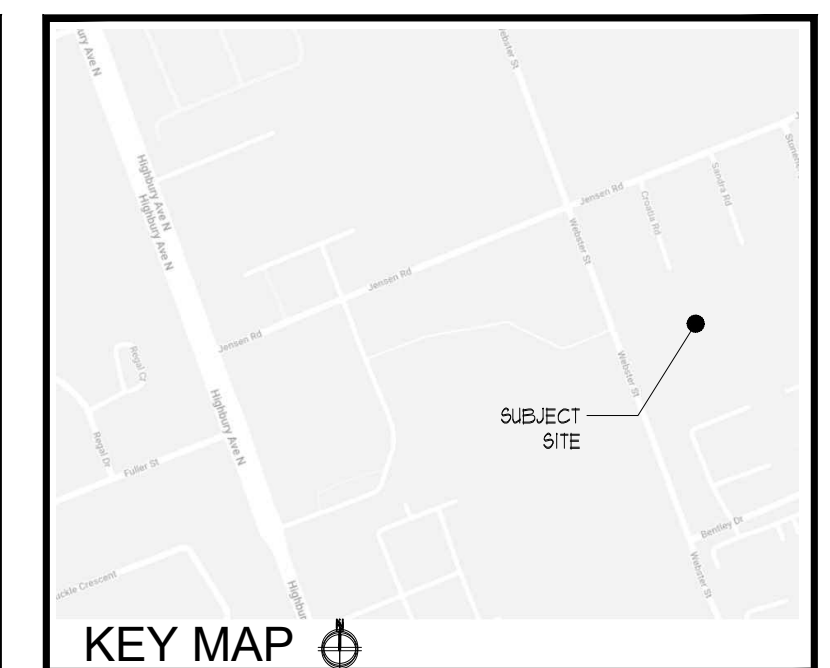

KEY MAP



ALL DRAWINGS REMAIN THE PROPERTY OF THE LANDSCAPE ARCHITECT AND SHALL NOT BE REPRODUCED OR REUSED WITHOUT THE LANDSCAPE ARCHITECTS WRITTEN PERMISSION.  
THIS DRAWING SHALL NOT BE USED FOR CONSTRUCTION OR TENDER PURPOSES UNLESS SIGNED AND DATED BY RONALD H. KOUDYS, O.A.A. C.S.L.A. LANDSCAPE ARCHITECT, LONDON, ONTARIO (519) 667-3322.

Ronald H. Koudys, O.A.A. C.S.L.A. DATE

DATE	DESCRIPTION	No.
2024-05-08	ISSUED FOR ZBA	2.
2024-03-14	ISSUED FOR REVIEW	1.

PLOTTING INFORMATION:  
PLOTTED DATE + 2024-05-08  
PLOTTED SCALE + 1:1

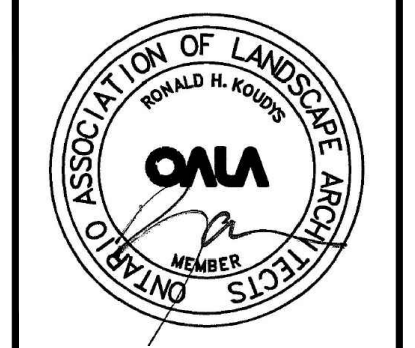
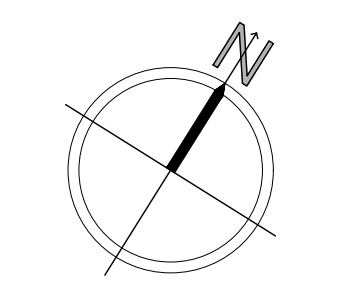

PROJECT TITLE:  
**2 STOREY TOWNHOMES**  
1356 WEBSTER STREET  
LONDON, ON

DRAWING TITLE:  
**LANDSCAPE PLAN**

DATE: MARCH, 2024	SCALE: AS NOTED	DRAWING No. <b>L-1</b>
DRAWN: RKL/A Inc.	CHECKED BY: RHK	
PROJECT No. 23-252Lc		