

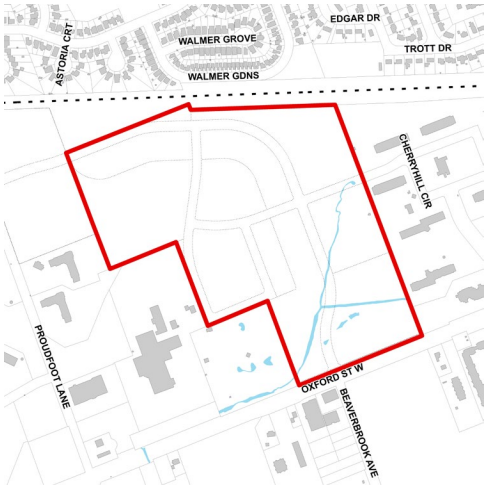

PUBLIC MEETING NOTICE

Draft Plan of Subdivision, Official Plan and Zoning By-law Amendment

323 Oxford Street West, 92 & 825 Proudfoot Lane



File: 39T-21505/Z-9416

Applicant: Sam Katz Holdings Inc.

What is Proposed?

Draft Plan of Subdivision, Official Plan and Zoning amendment to allow:

- a proposed draft plan of subdivision consisting of three (3) medium density residential blocks; three (3) high density blocks; three (3) park blocks; six (6) open space blocks; one (1) road widening block; four (4) one foot reserve blocks; all served by the extension of Westfield Drive, Beaverbrook Avenue and two (2) new local streets

YOU ARE INVITED!

Further to the Notice of Application you received on October 16, 2023, you are invited to a public meeting of the Planning and Environment Committee to be held:

Meeting Date and Time: Tuesday, June 11, 2024, no earlier than 1:30 p.m.

Meeting Location: The Planning and Environment Committee Meetings are hosted in City Hall, Council Chambers; virtual participation is also available, please see City of London website for details.

For more information contact:

Sean Meksula
smeksula@london.ca
519-661-CITY (2489) ext. 5349
Development Services, City of London
300 Dufferin Avenue, 6th Floor,
London ON PO Box 5035 N6A 4L9
File: 39T-21505/Z-9416

london.ca/planapps

To speak to your Ward Councillor:

Sam Trosow
strosow@london.ca
519-661-CITY (2489) ext. 4006

If you are a landlord, please post a copy of this notice where your tenants can see it. We want to make sure they have a chance to take part.

Date of Notice: May 14, 2024

Application Details

Requested Draft Plan of Subdivision

Consideration of a Draft Plan of Subdivision consisting of three (3) medium density residential blocks; three (3) high density blocks; three (3) park blocks; six (6) open space blocks; one (1) road widening block; one (1) road reserve block; serviced by four (4) local streets (Streets A, B, Beaverbrook Avenue, and Westfield Drive).

Requested Official Plan Amendment

To amend the Specific Area policy for the Neighbourhood Place Type, High Density Overlay (from the 1989 Official Plan) Transit Rapid Transit Place Type to permit a maximum height of 18 storeys (60 metres) and delineate the subject lands on Map 7 (Specific Policy Areas) of The London Plan.

Requested Zoning By-law Amendment

To change the zoning from a **FROM** a Holding Residential R5/R6/R7/R8 (h-1/R5-3/R6-5/R7/D75/H13/R8-4), Residential R5/R6/R7/R8, Neighbourhood Facility (R5-3/R6-5/R7/D75/H13/R8-4/NF1), Holding Residential R8 (h-1/R8-4), Holding Residential Special Provision R8 (h-1/R8-4(9)), Residential R9 (R9-7/H40), Residential R9 (R9-7/H46) Holding Residential Special Provision R9 (h-1/R9-3(8)/H22), Open Space (OS1), and Open Space (OS4) Zones **TO** a Holding Residential R5 Special Provision (h-1/h-80/h-100/R5-7(**)/D75/H13), Holding Residential R9 Special Provision/Neighbourhood Shopping Area (h-1/h-80/h-100/R9-7(**)/D305/H60/NSA3), Holding Residential R9 Special Provision (h-1/h-80/h-100/R9-7(**)/D242/H46), Holding Residential R9 Special Provision (h-1/h-80/h-100/R9-7(**)/D230/H20), Holding Residential R9 Special Provision/Neighbourhood Facility/Open Space (h-1/R9-7(**)/D240/H40/NF/OS1), Holding Residential R9 Special Provision (h-1/h-80/h-100/R9-7(**)/D200), OS1 and Open Space (OS5) Zone. Changes to the currently permitted land uses and development regulations are summarized below.

The Zoning By-law is available at london.ca.

Requested Zoning (Please refer to attached map)

Zone(s):

- **Block 1 - Holding Residential R9 Special Provision/Neighbourhood Shopping Area (h-1/h-80/h-100/R9-7(**)/D305/H60/NSA3) Zone** - to permit apartment buildings, lodging house class 2, senior citizen apartment buildings, handicapped person's apartment buildings, and continuum-of-care facilities together with a special provision for additional permitted uses: cluster stacked townhouse dwelling, cluster townhouses, and uses permitted within the NSA3 Zone variation, building setbacks for apartments, south property line (Oxford Street West) 6.0 metres maximum / 0.0 metres minimum, west property line (Beaverbrook Avenue) 6.0 metres maximum / 3.0 metres minimum, north property line (Westfield Drive) 6.0 metres maximum / 3.0 metres minimum, east property line 6.0 metres, density maximum of 305 units/ha, height (maximum) 60.0 metres (18 storeys), for towers with frontage on Oxford Street West: from established grade along Oxford Street West 60.0 metres (18 storeys), from established grade in development block 60.0 metres (18 storeys), for towers with frontage on Westfield Drive 46.0 metres (14 storeys), for towers internal to the development block 60.0 metres (18 storeys), built form percentage along streetscape 50% minimum, building step back after 4th storey 3.0 metres minimum, maximum point tower floorplate 1,000m² for towers with frontage on Oxford Street West, Tower Separation 25.0 metres minimum, coverage 45% maximum and a landscape open space 30% minimum. The NSA Zone provides for and regulates a range of neighbourhood-scale retail, personal service and office uses which are primarily intended to provide for the convenience shopping and service needs of nearby residents;
- **Block 2 - Holding Residential R9 Special Provision (h-1/h-80/h-100/R9-7(**)/D242/H46) Zone** - to permit apartment buildings, lodging house class 2, senior citizen apartment buildings, handicapped person's apartment buildings, and continuum-of-care facilities, together with a special provision for additional permitted uses: cluster stacked townhouse dwelling and cluster townhouses, building setbacks, front yard 6.0 metres maximum and 0.0 metres minimum, exterior side yard 6.0 metres and 3.0 metres minimum, north property line 3.0 metres, east property line 6.0 metres, 12.0 metres above 8th storey minimum, density maximum of 242 units/ha, height maximum 46.0 metres (14 storeys), built form percentage along streetscape 50% minimum, building stepback after 4th storey 3.0 metres minimum,

tower separation 25.0 metres minimum, coverage 45% maximum and landscape open space 30% minimum;

- **Block 3 - Holding Residential R9 Special Provision (h-1/h-80/h-100/R9-7(**)/D230/H20) Zone** - to permit apartment buildings, lodging house class 2, senior citizen apartment buildings, handicapped person's apartment buildings, and continuum-of-care facilities, together with a special provision for additional permitted uses: cluster stacked townhouse dwelling; cluster townhouses; together with a special provision for additional permitted uses: cluster stacked townhouse dwelling and cluster townhouses; setbacks for apartment buildings, front yard 6.0 metres maximum/3.0 metres minimum, exterior side yard 6.0 metres maximum/3.0 metres minimum, interior side yard 5.0 metres and rear yard 5.0 meters; setbacks for townhouse dwellings, front yard 3.0 metres maximum, exterior side yard 3.0 metres, interior side yard 1.5 metres and rear yard 3.0 metres, density maximum of 230 units/ha, height 20.0 metres (maximum), (6 storeys), built form percentage along streetscape 50% minimum, coverage 45% maximum and landscape open space 30% minimum;
- **Blocks 4 and 5 - Holding Residential R5 Special Provision (h-1/h-80/h-100/R5-7(**)/D75/H13) Zone** - to permit such uses as townhouses and stacked townhouses up to a maximum density of 75 units per hectare and maximum height of 12 metres, together with a special provision for additional permitted use(s): cluster stacked townhouse dwelling; with building setbacks, front and rear yard 3.0 metres, exterior and interior side yard 1.5 metres, Density of 75 units/ha, height 13.0 metres maximum, (4 storeys), coverage 45% maximum and landscape open space 30% minimum;
- **Block 6 - Holding Residential R9 Special Provision/Neighbourhood Facility/Open Space (h-1/R9-7(**)/D240/H40/NF/OS1)** – to permit apartment buildings, lodging house class 2, senior citizen apartment buildings, handicapped person's apartment buildings, and continuum-of-care facilities, together with a special provision for additional permitted uses: cluster stacked townhouse dwelling and cluster townhouses; setbacks for apartment buildings, front yard 6.0 metres maximum/3.0 metres minimum, exterior side yard 6.0 metres maximum/3.0 metres minimum, east interior (Open Space) side yard 3.0 metres maximum and south property line 6.0 meters maximum; setbacks for townhouse dwellings, front yard 3.0 metres maximum, exterior side yard 3.0 metres maximum, interior side 1.5 metres maximum and rear yard 3.0 metres maximum, density maximum of 240 units/ha, height 40.0 metres maximum, (13 storeys), building stepback after 4th storey 3.0 metres minimum, tower separation 25.0 metres minimum, built form percentage along streetscape 50% minimum, coverage 45% maximum and landscape open space 30% minimum. The Neighbourhood Facility zone provides for and regulates public and private facility uses which primarily serve a neighbourhood function. They include small to medium scale uses which have minimal impact on surrounding land uses and may be appropriate adjacent to or within residential neighbourhoods. The NF Zone variation permits the lowest impact uses permitted in the zone and typically uses are developed independently. The following are permitted uses in the NF Zone variation, places of worship, elementary schools, and day care centres. The OS1 Zone permits such uses as conservation lands, conservation works, golf courses, public and private parks, recreational buildings associated with conservation lands and public parks, campgrounds, and managed forests;
- **Block 7 - Holding Residential R9 Special Provision (h-1/h-80/h-100/R9-7(**)/D200)** - to permit apartment buildings, handicapped person's apartment buildings, lodging house class 2, stacked townhousing, senior citizen apartment buildings, emergency care establishments, continuum-of-care facilities and maximum height of 16 metres, together with a special provision for additional permitted uses: cluster stacked townhouse dwelling setbacks for apartment buildings, front yard 6.0 metres maximum/3.0 metres minimum, north property line 30.0 meters; setbacks for townhouse dwellings, front yard 3.0 metres maximum, west property line 5.0 metres maximum, north property line 3.0 metres, density maximum of 200 units/ha, height 13.0 metres (4 storeys) within 72 metres of the west property boundary; otherwise 40.0 metres maximum, (12 storeys), building stepback after 4th storey 3.0 metres minimum, tower separation 25.0 metres minimum, built form percentage along streetscape 50% minimum, coverage 45% maximum and landscape open space 30% minimum;
- **Blocks 9, 10, 11, 12 - OS1 Zone** - to permit such uses as conservation lands, conservation works, golf courses, public and private parks, recreational buildings associated with conservation lands and public parks, campgrounds, and managed forests; and,

- **Blocks 8, 13, 14, 15 - OS5 Zone** - to permit conservation lands, conservation works, passive recreation uses which include hiking trails and multi-use pathways, and managed woodlots.

The City may also consider applying holding provisions in the zoning to ensure adequate provision of municipal services, that a subdivision agreement or development agreement is entered into, and to ensure completion of noise assessment reports and implementation of mitigation measures for development adjacent arterial roads.

A revised Environmental Impact Study (EIS) report prepared by MTE Consultants, revised March 8, 2024, has been submitted with the application for draft plan of subdivision. The EIS report is available for viewing by contacting the City's Planner listed below. File: 39T-21505 / Z-9416 Planner: S. Meksula (City Hall).

Planning Policies

Any change to the Zoning By-law must conform to the policies of the Official Plan, London's long-range planning document. These lands are currently designated as Multi-family, Medium Density Residential, Multi-family, High Density Residential, and Open Space in the Official Plan, which permits single detached, semi-detached, duplex and multiple attached dwellings, such as row houses or cluster houses; low-rise apartment buildings; and small-scale nursing homes, rest homes, and homes for the aged; low-rise and high-rise apartment buildings; apartment hotels; multiple-attached dwellings; emergency care facilities; nursing home; rest homes; homes for the aged; and rooming and boarding houses. public open space uses such as public parks, and private open space uses such as cemeteries and private golf courses, as the main uses. The subject lands are in the 'Neighbourhoods' and 'Green Space' Place Types in *The London Plan*.

How Can You Participate in the Planning Process?

You have received this Notice because someone has applied for a Draft Plan of Subdivision and to change the zoning of land located within 120 metres of a property you own, or your landlord has posted the public meeting notice in your building. The City reviews and makes decisions on such planning applications in accordance with the requirements of the Planning Act. If you previously provided written or verbal comments about this application, we have considered your comments as part of our review of the application and in the preparation of the planning report and recommendation to the Planning and Environment Committee. The additional ways you can participate in the City's planning review and decision-making process are summarized below.

See More Information

You can review additional information and material about this application by:

- Contacting the City's Planner listed on the first page of this Notice; or
- Viewing the application-specific page at london.ca/planapps
- Opportunities to view any file materials in-person by appointment can be arranged through the file Planner.

Attend This Public Participation Meeting

The Planning and Environment Committee will consider the requested Draft Plan of Subdivision and zoning changes at this meeting, which is required by the Planning Act. You will be invited to provide your comments at this public participation meeting. A neighbourhood or community association may exist in your area. If it reflects your views on this application, you may wish to select a representative of the association to speak on your behalf at the public participation meeting. Neighbourhood Associations are listed on the [Neighbourgood](https://neighbourgood.ca) website. The Planning and Environment Committee will make a recommendation to Council, which will make its decision at a future Council meeting. The Council Decision will inform the decision of the Director, Planning & Development, who is the Approval Authority for Draft Plans of Subdivision.

What Are Your Legal Rights?

Notification of Council and Approval Authority's Decision

If you wish to be notified of the Approval Authority's decision in respect of the proposed draft plan of subdivision, you must make a written request to the Director, Planning & Development, City of London, 300 Dufferin Ave., P.O. Box 5035, London ON N6A 4L9, or at plandev@london.ca. You will also be notified if you provide written comments, or make a written request to the City of London for conditions of draft approval to be included in the Decision.

If you wish to be notified of the decision of the City of London on the proposed zoning by-law amendment, you must make a written request to the City Clerk, 300 Dufferin Ave., P.O. Box

5035, London, ON, N6A 4L9, or at docservices@london.ca. You will also be notified if you speak to the Planning and Environment Committee at the public meeting about this application and leave your name and address with the Clerk of the Committee.

Right to Appeal to the Ontario Land Tribunal

If a person or public body does not make oral submissions at a public meeting, if one is held, or make written submissions to the City of London in respect of the proposed plan of subdivision before the approval authority gives or refuses to give approval to the draft plan of subdivision, the person or public body is not entitled to appeal the decision of the Director, Planning & Development to the Ontario Land Tribunal.

If a person or public body does not make oral submissions at a public meeting, if one is held, or make written submissions to the City of London in respect of the proposed plan of subdivision before the approval authority gives or refuses to give approval to the draft plan of subdivision, the person or public body may not be added as a party to the hearing of an appeal before the Ontario Land Tribunal unless, in the opinion of the Tribunal, there are reasonable grounds to do so.

If a person or public body would otherwise have an ability to appeal the decision of the Council of the Corporation of the City of London to the Ontario Land Tribunal but the person or public body does not make oral submissions at a public meeting or make written submissions to the City of London before the by-law is passed, the person or public body is not entitled to appeal the decision.

If a person or public body does not make oral submissions at a public meeting or make written submissions to the City of London before the by-law is passed, the person or public body may not be added as a party to the hearing of an appeal before the Ontario Land Tribunal unless, in the opinion of the Tribunal, there are reasonable grounds to add the person or public body as a party.

For more information go to <https://olt.gov.on.ca/appeals-process/forms/>.

Notice of Collection of Personal Information

Personal information collected and recorded at the Public Participation Meeting, or through written submissions on this subject, is collected under the authority of the Municipal Act, 2001, as amended, and the Planning Act, 1990 R.S.O. 1990, c.P.13 and will be used by Members of Council and City of London staff in their consideration of this matter. The written submissions, including names and contact information and the associated reports arising from the public participation process, will be made available to the public, including publishing on the City's website. Video recordings of the Public Participation Meeting may also be posted to the City of London's website. Questions about this collection should be referred to Evelina Skalski, Manager, Records and Information Services 519-661-CITY(2489) ext. 5590.

Accessibility

The City of London is committed to providing accessible programs and services for supportive and accessible meetings. We can provide you with American Sign Language (ASL) interpretation, live captioning, magnifiers and/or hearing assistive (t coil) technology. Please contact us at plandev@london.ca by June 4, 2024 to request any of these services.

Requested Draft Plan of Subdivision



The above image represents the applicant's proposal as submitted and may change.

Requested Zoning

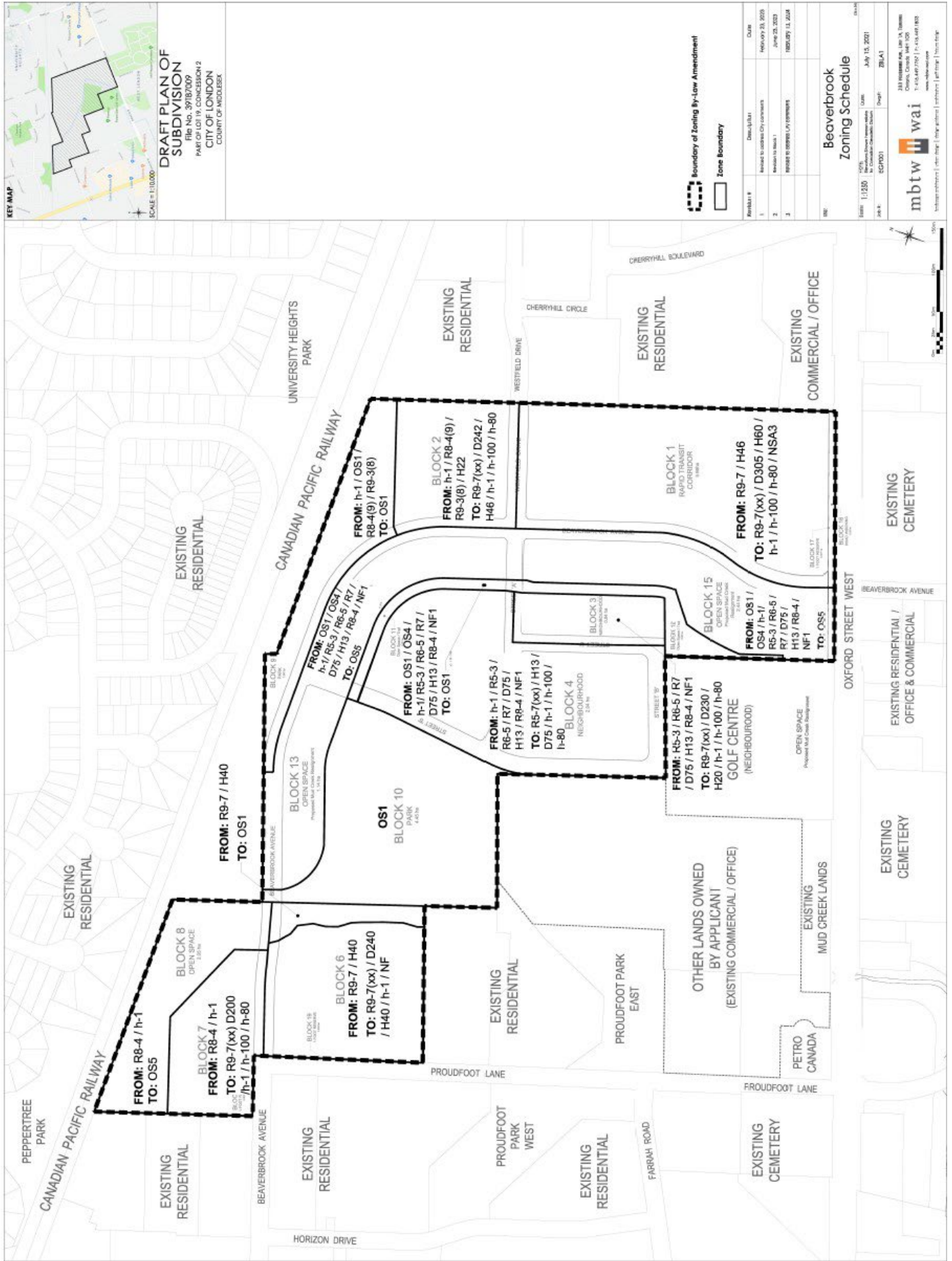

The above image represents the applicant's proposal as submitted and may change.